

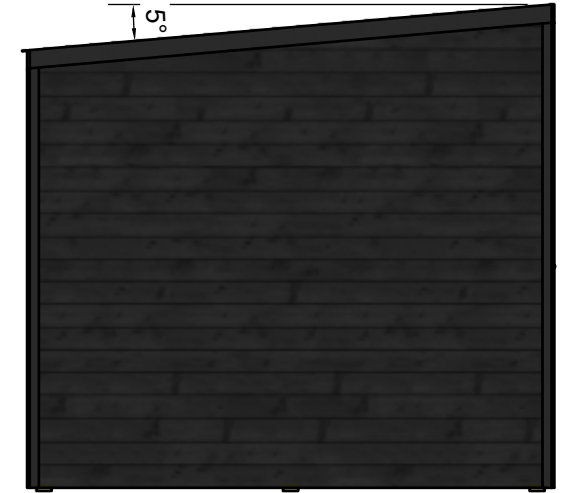

FRONT



LEFT



BACK

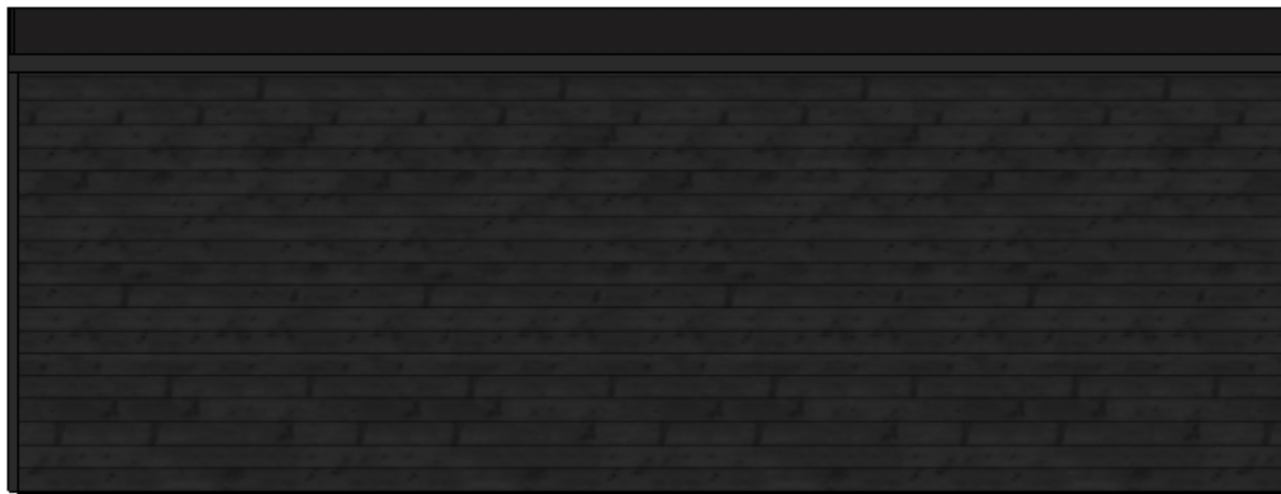

RIGHT

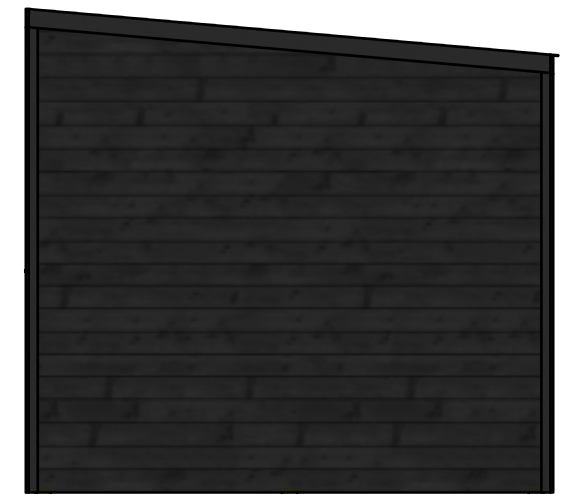

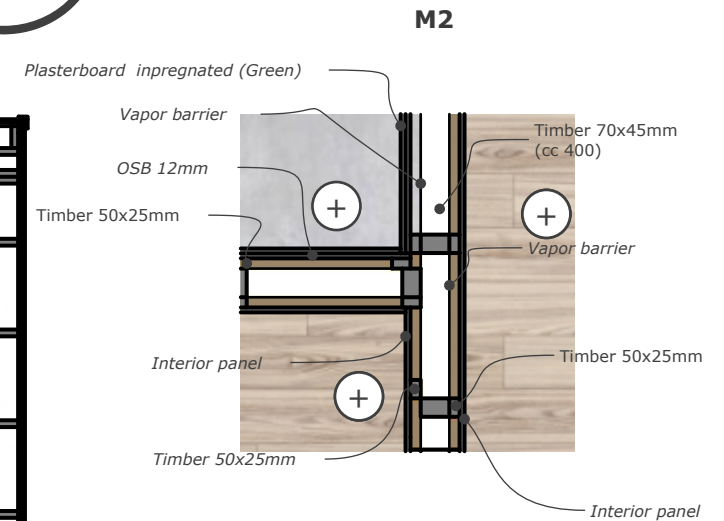
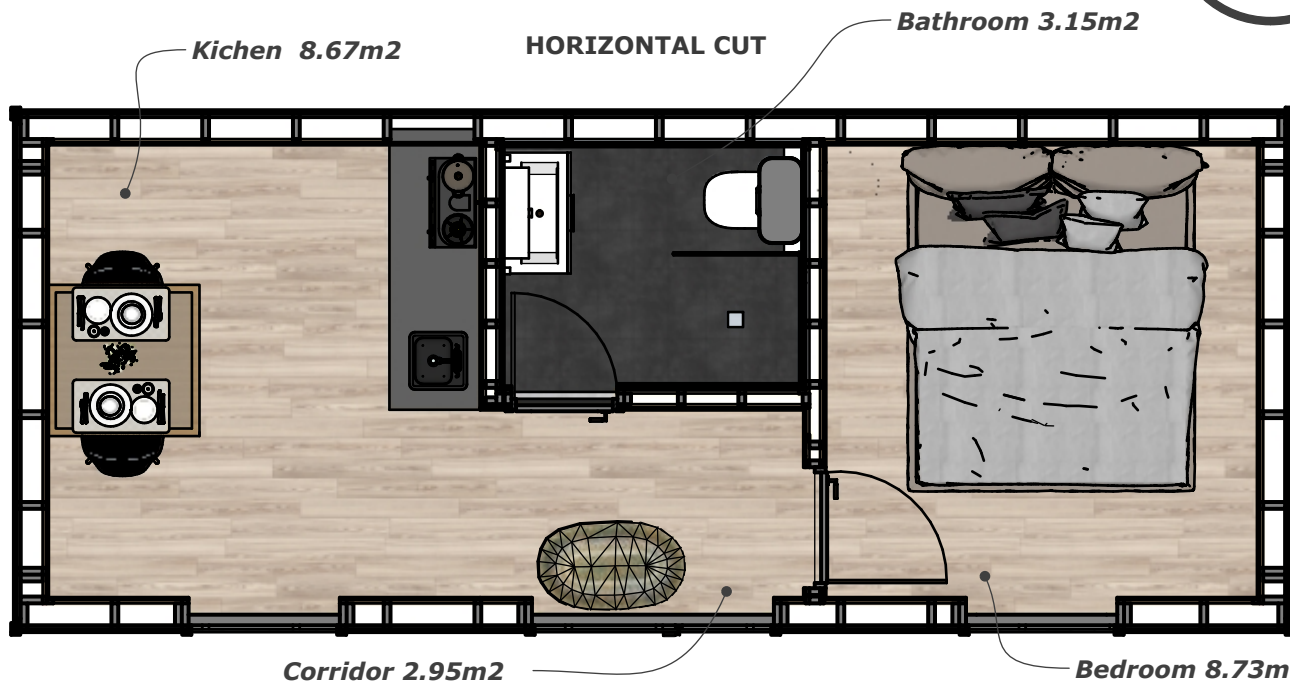
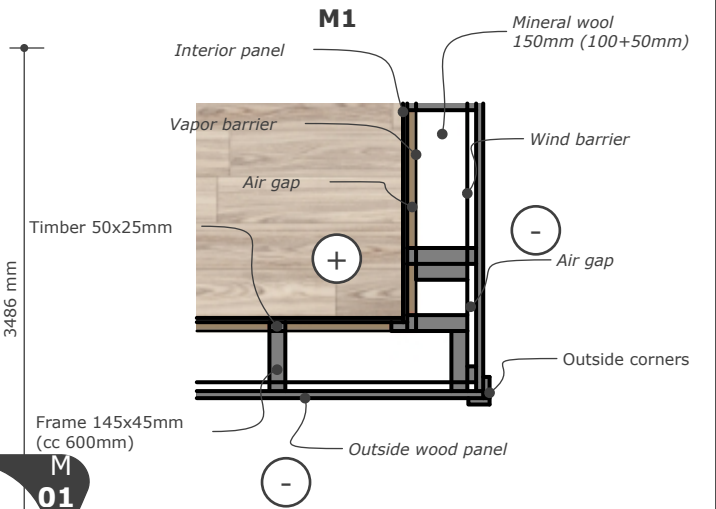
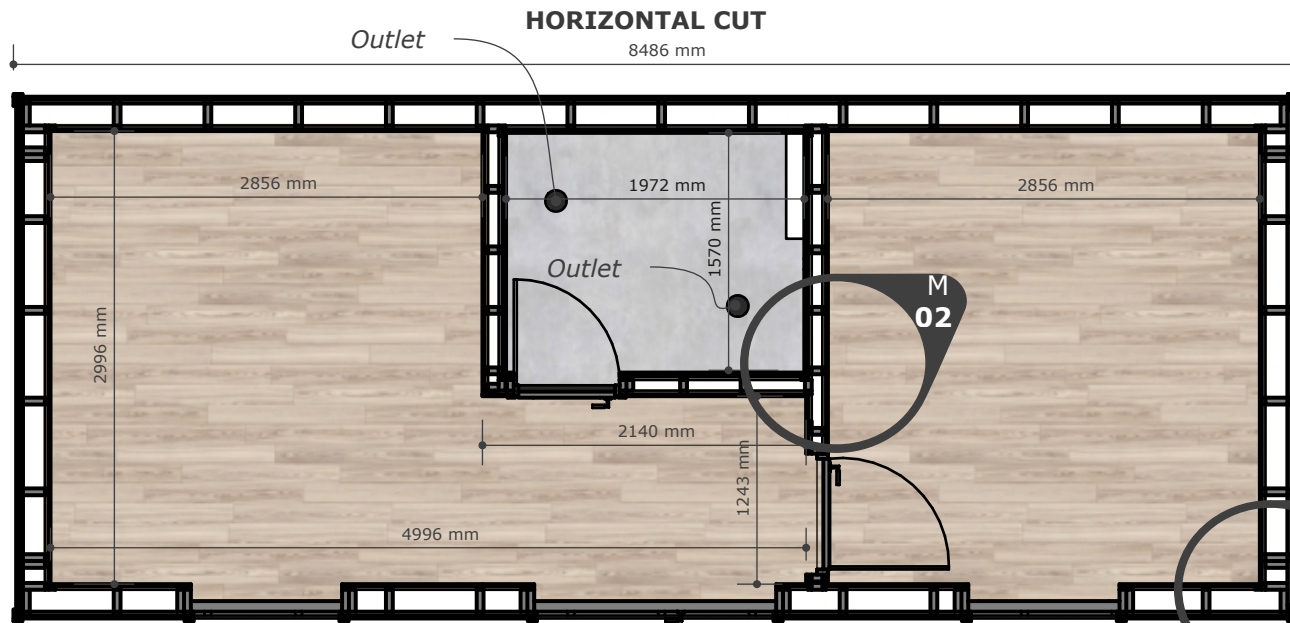

VERTICAL CUT

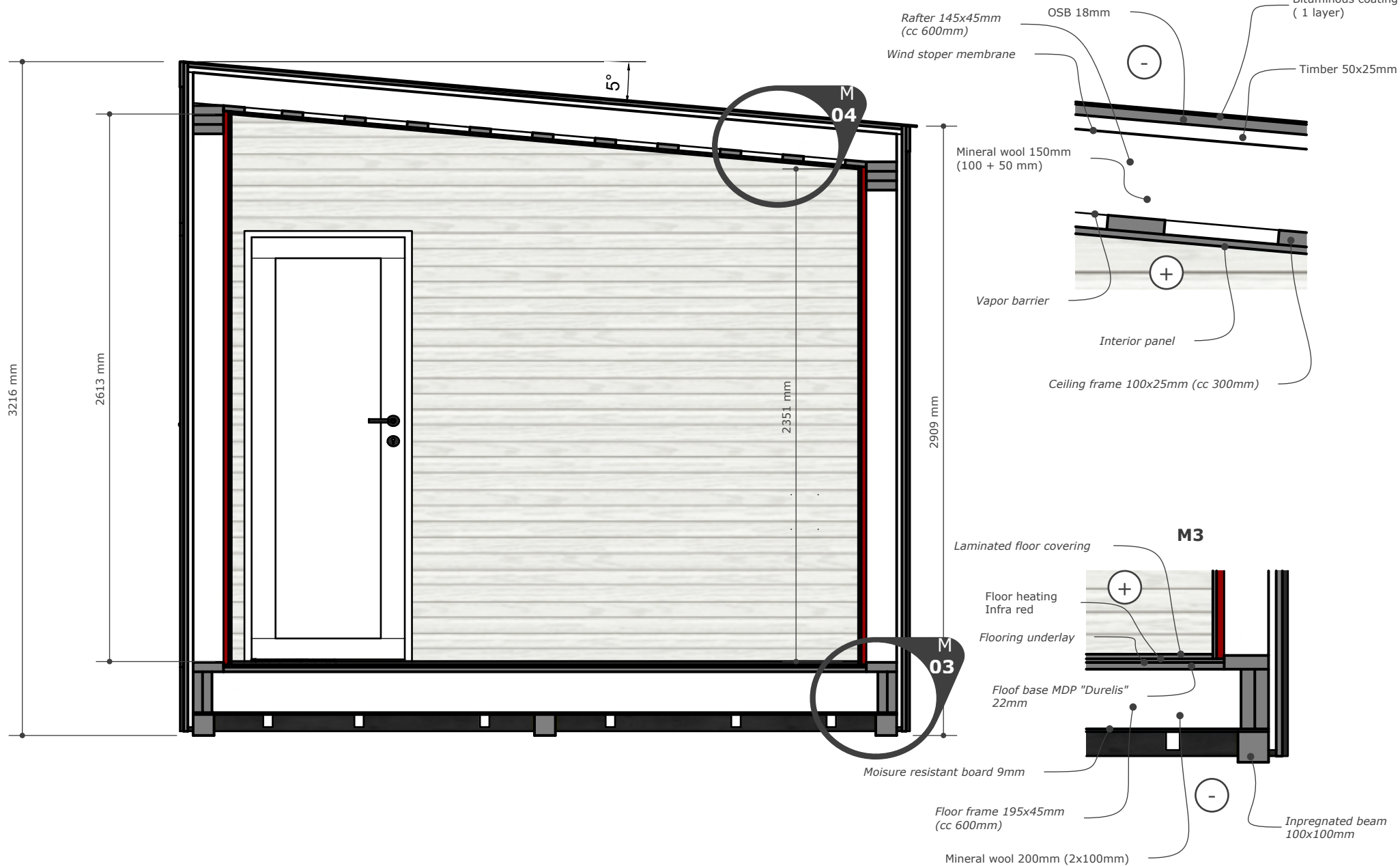



FRONT



6486 mm

LEFT



3468 mm

BACK

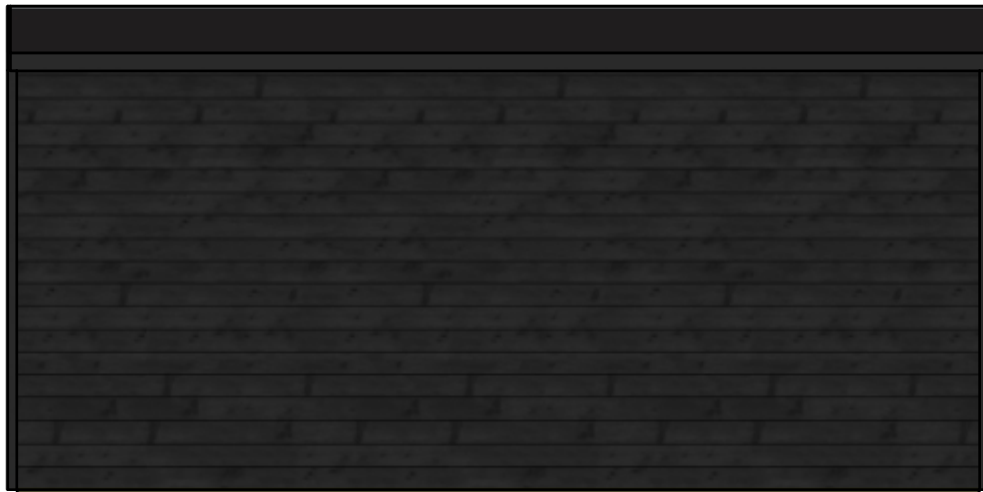

RIGHT

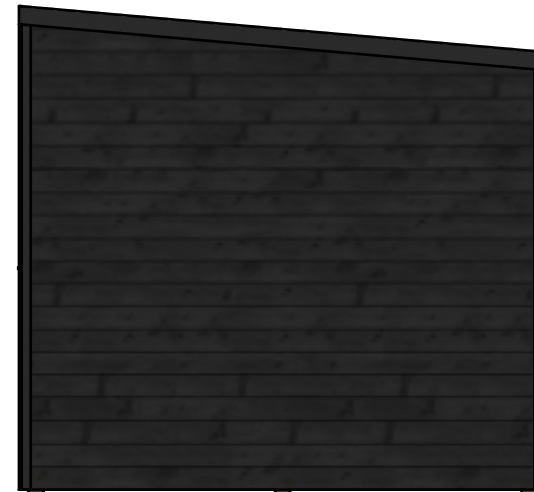

HORIZONTAL CUT

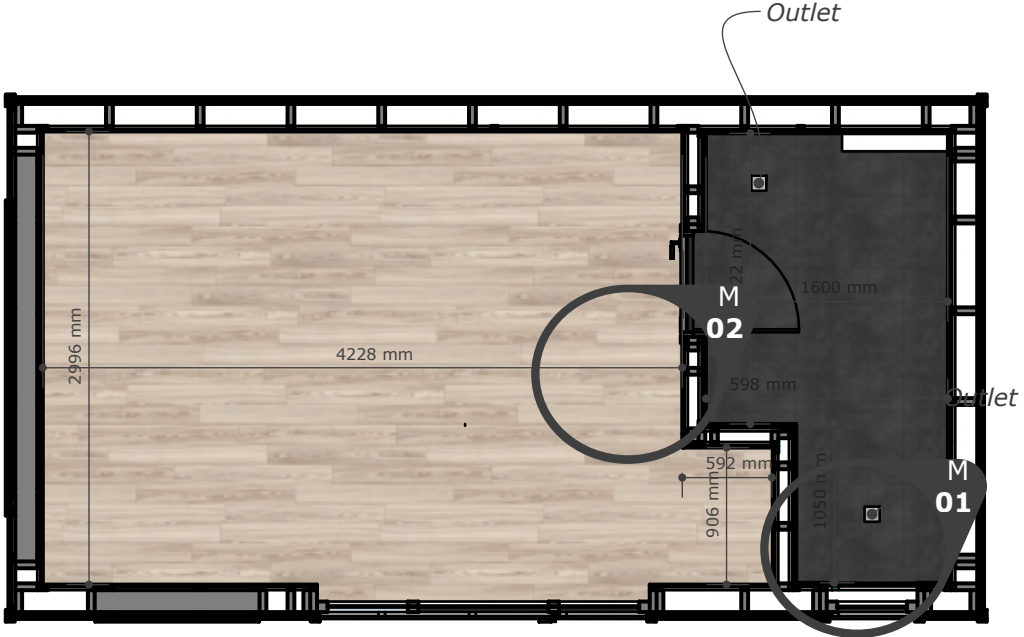

HORIZONTAL CUT

Bedroom
13.51m²
Bathroom
4.58m²

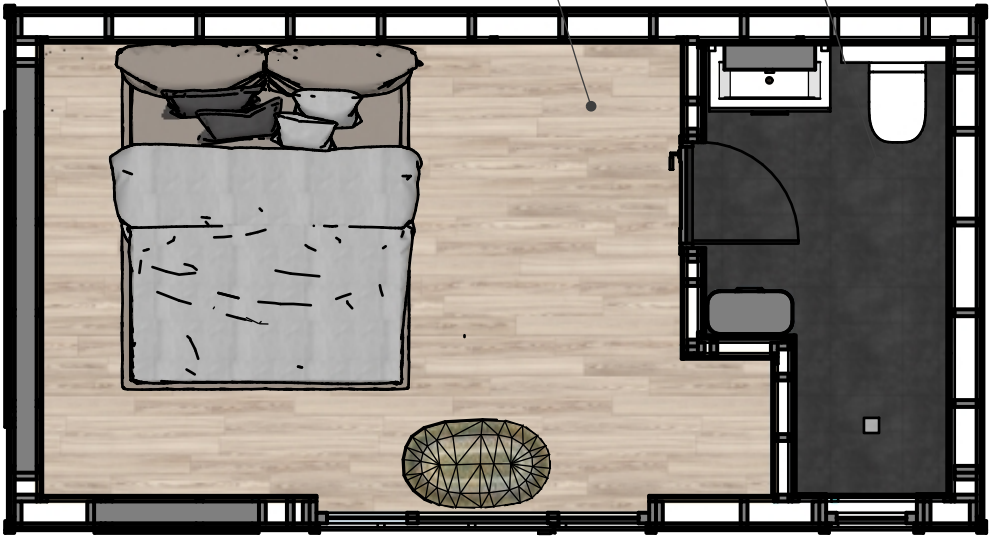

PLUMBING HOUSE 8,5X3,5M

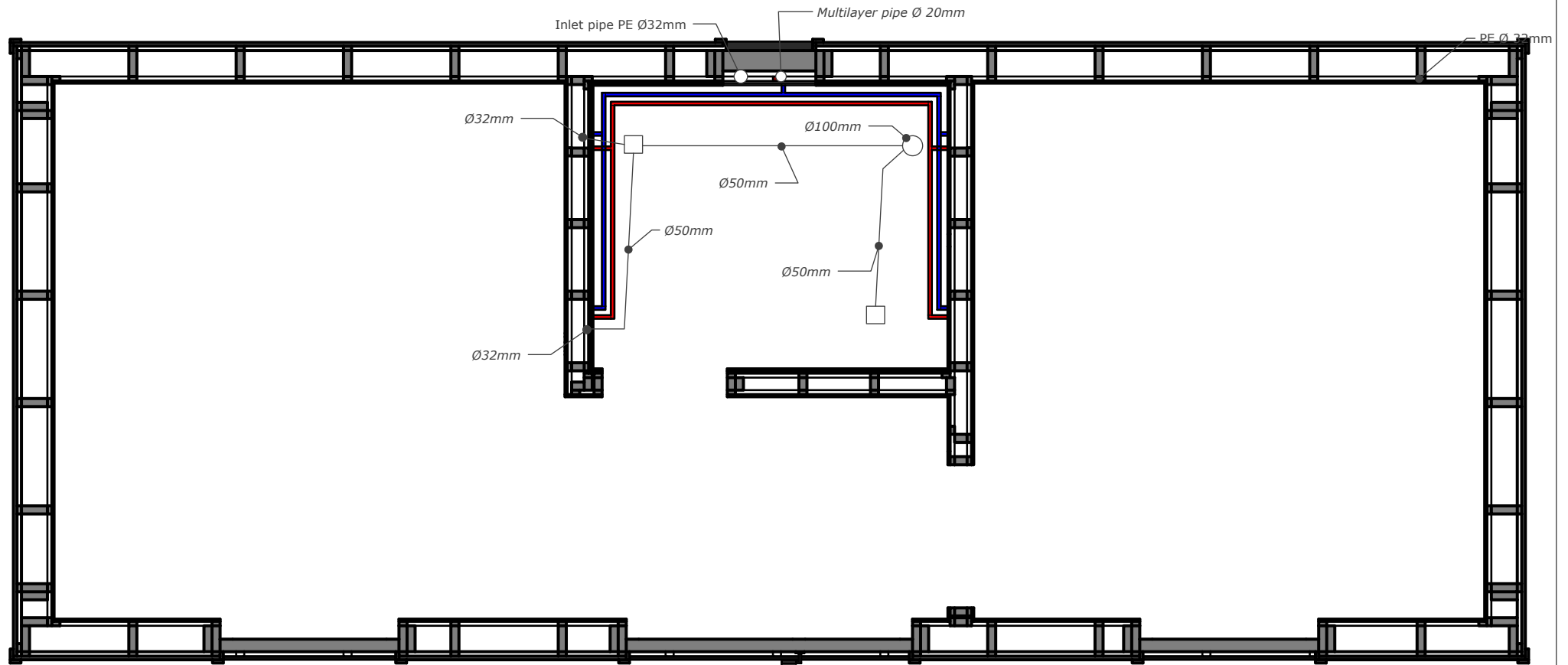



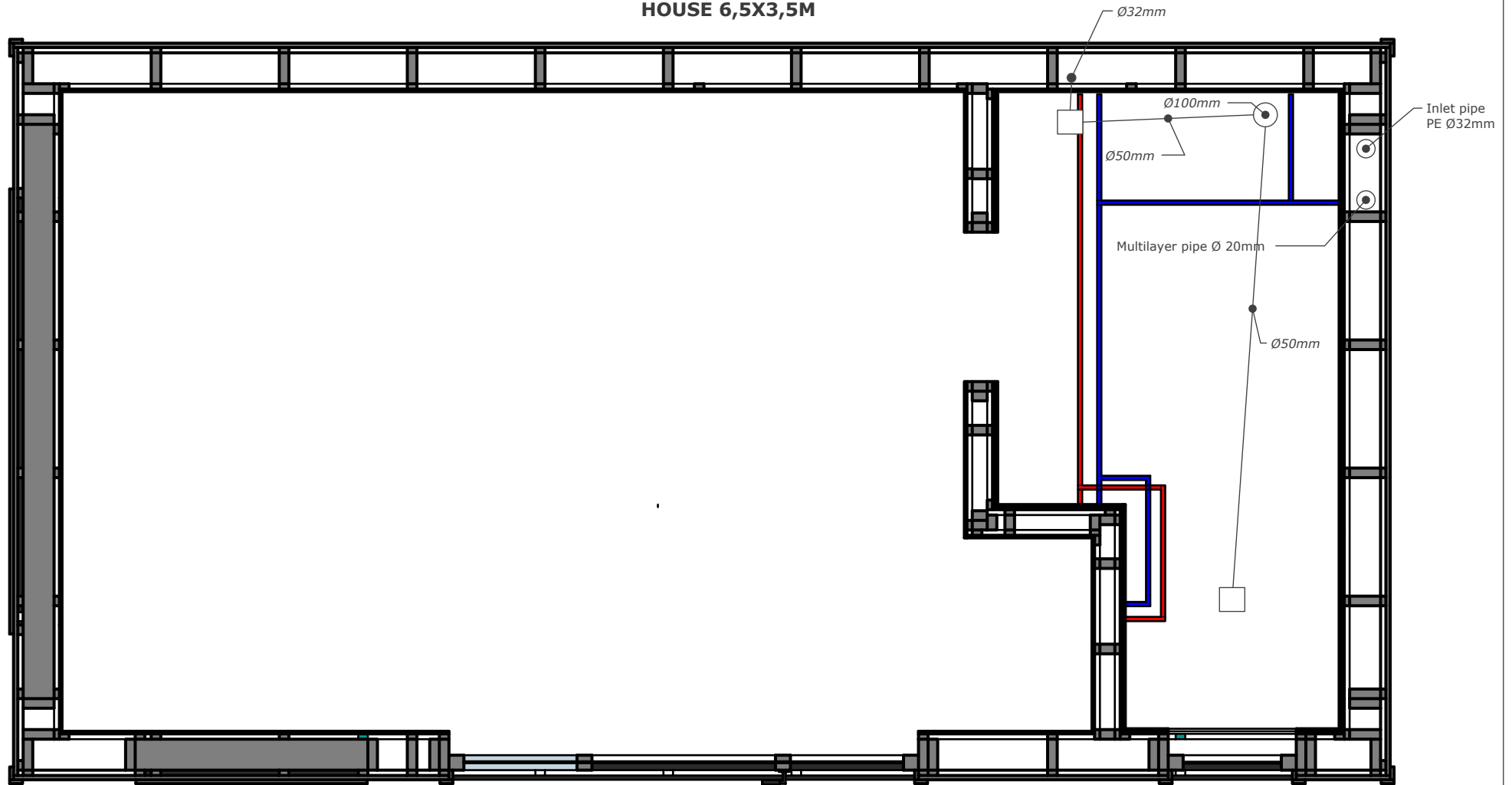

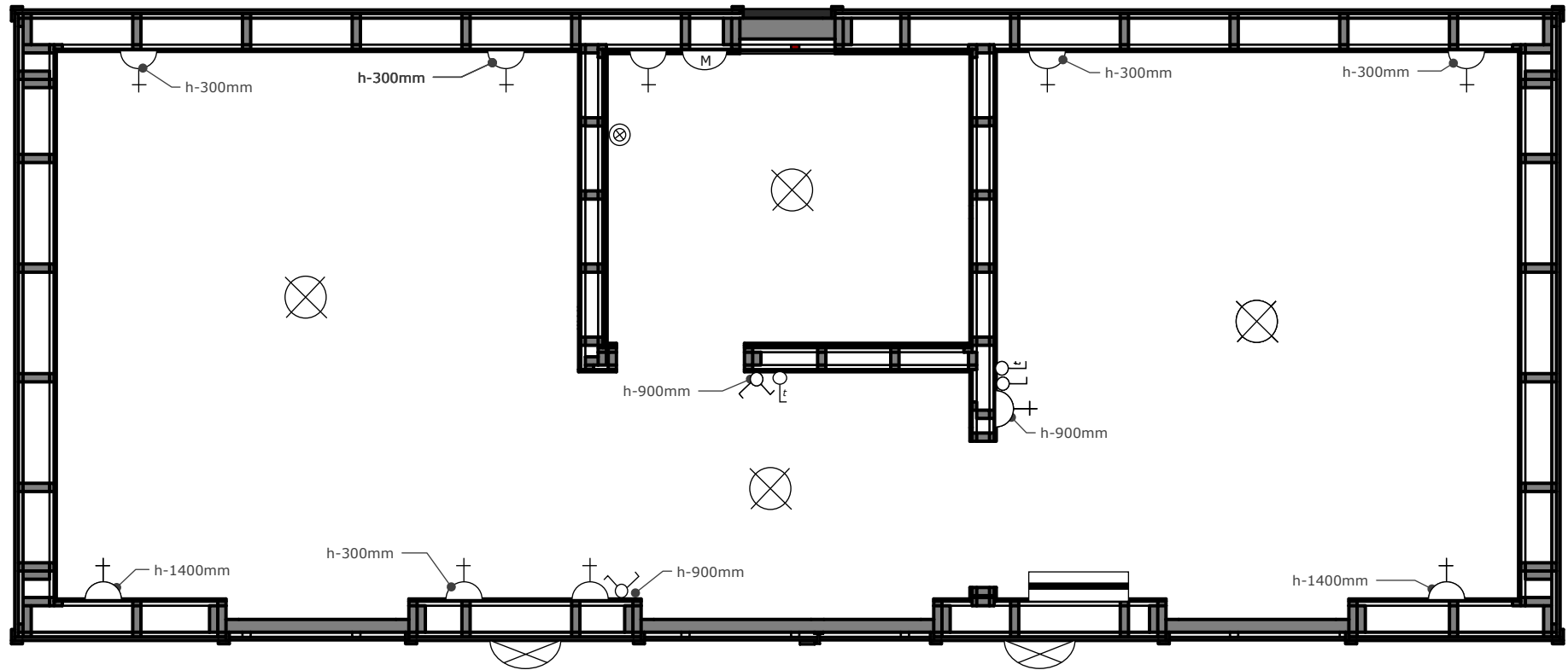

**PLUMBING
HOUSE 6,5X3,5M**



ELECTRICAL INSTALLATION HOUSE 8,5X3,5M

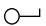
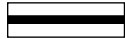
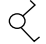

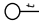
- | | |
|--|---|
|  - Lamp |  - Outside lamp |
|  - Outlet |  - Fan |
|  - Light switch |  - Electrical panel |
|  - Double light switch |  - Mirror lighting |
|  - Thermostat | |

**ELECTRICAL INSTALLATION
HOUSE 6,5X3,5M**

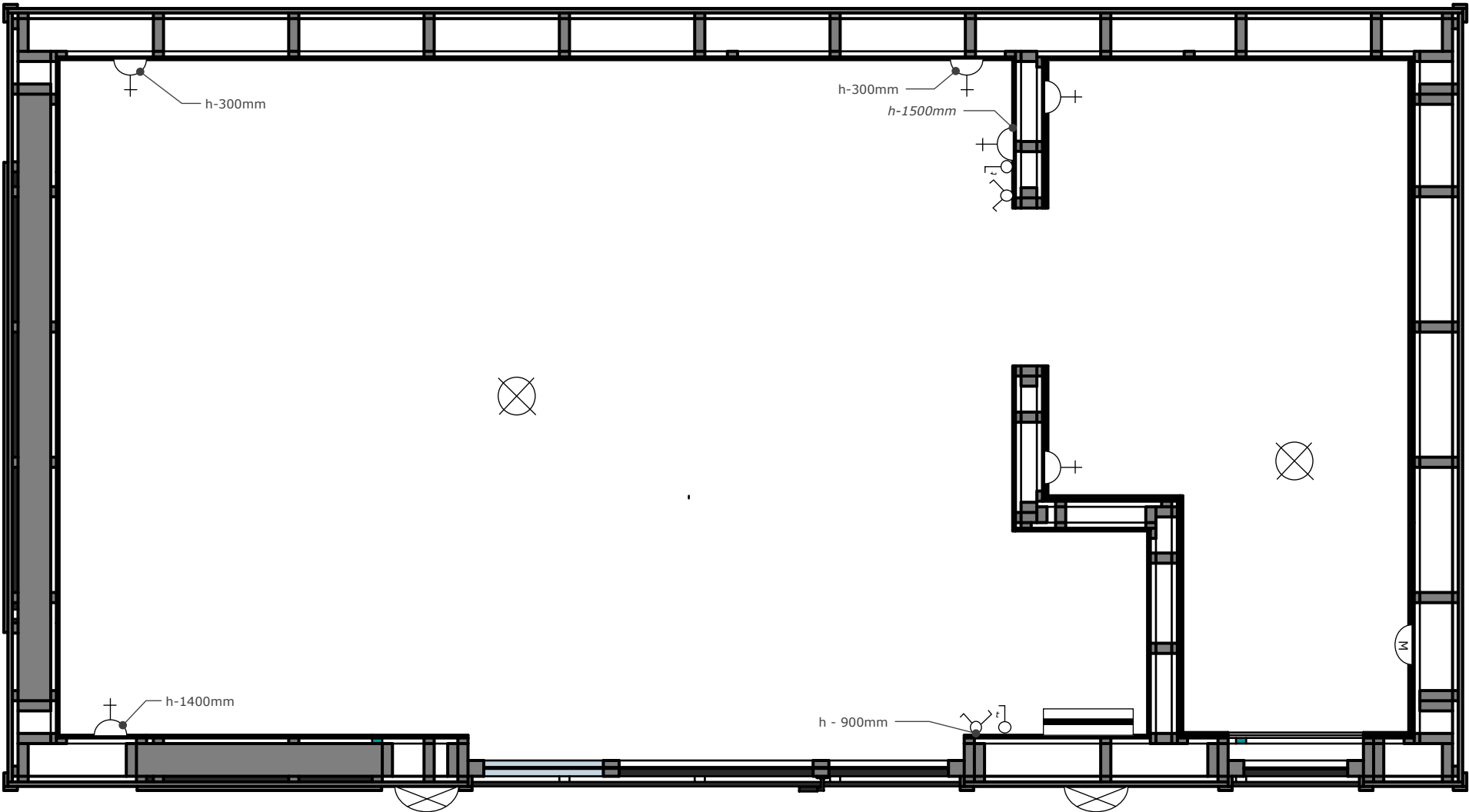

⊗ - Lamp

⊕ - Double light switch

Σ - Fan

⊕ - Outlet

T - Thermostat

▬ - Electrical panel

⊕ - Light switch

⊕ - Outside lamp

⊗ - Mirror lighting

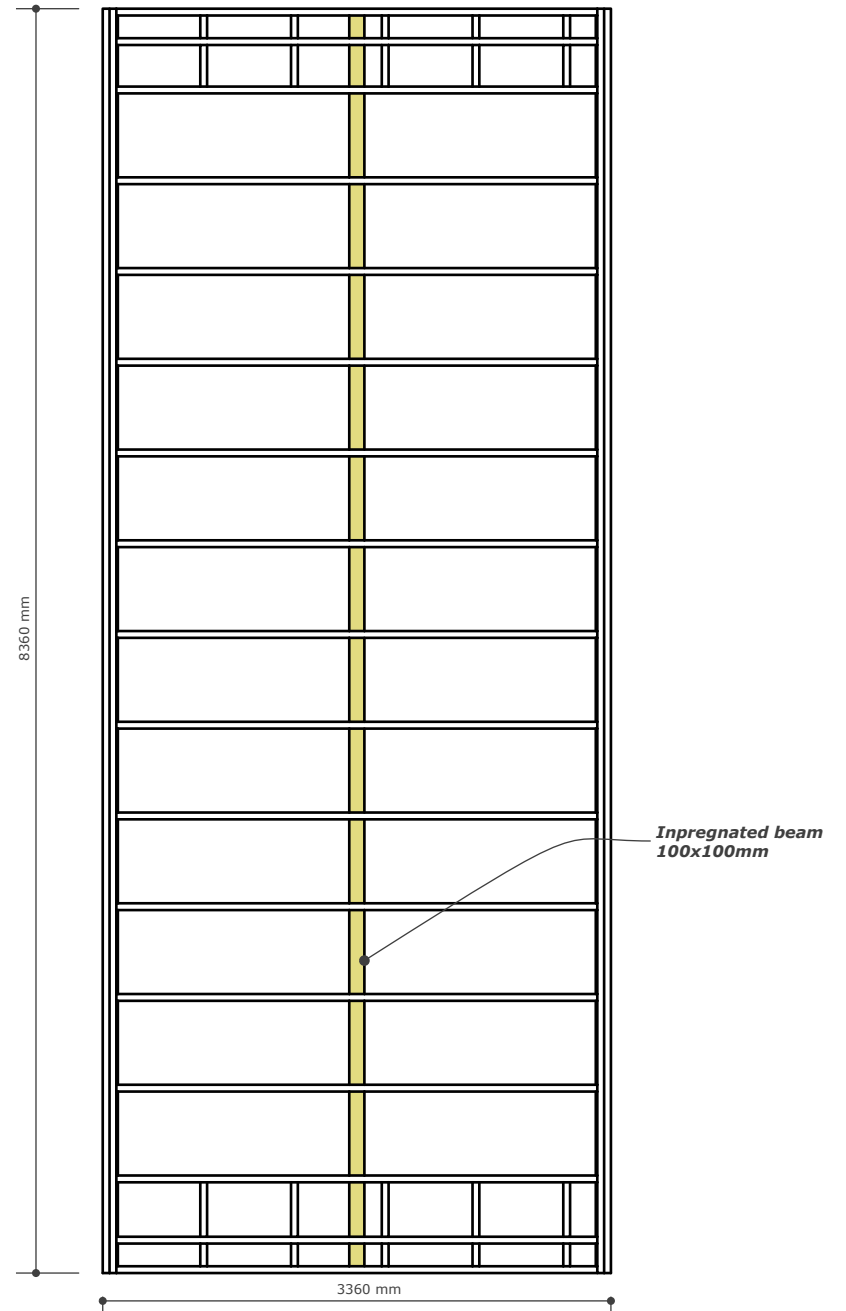
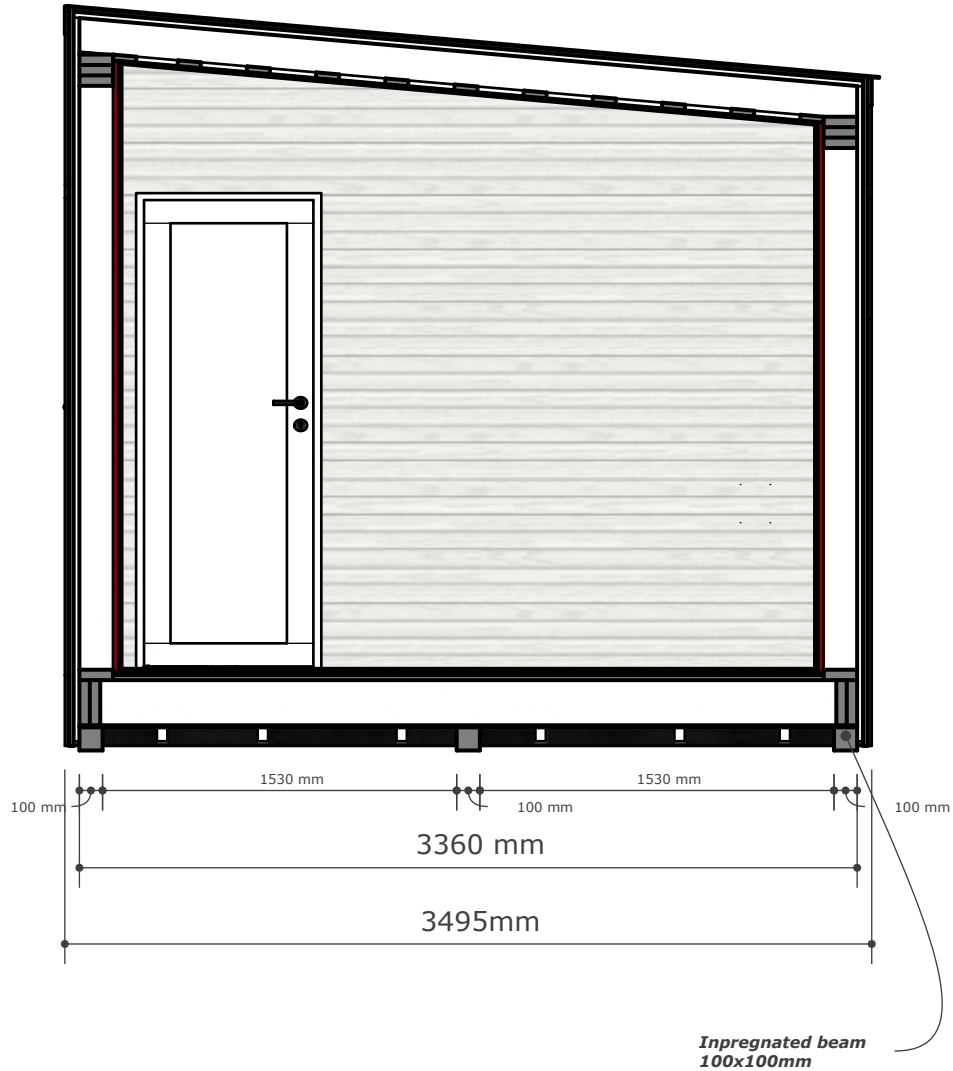

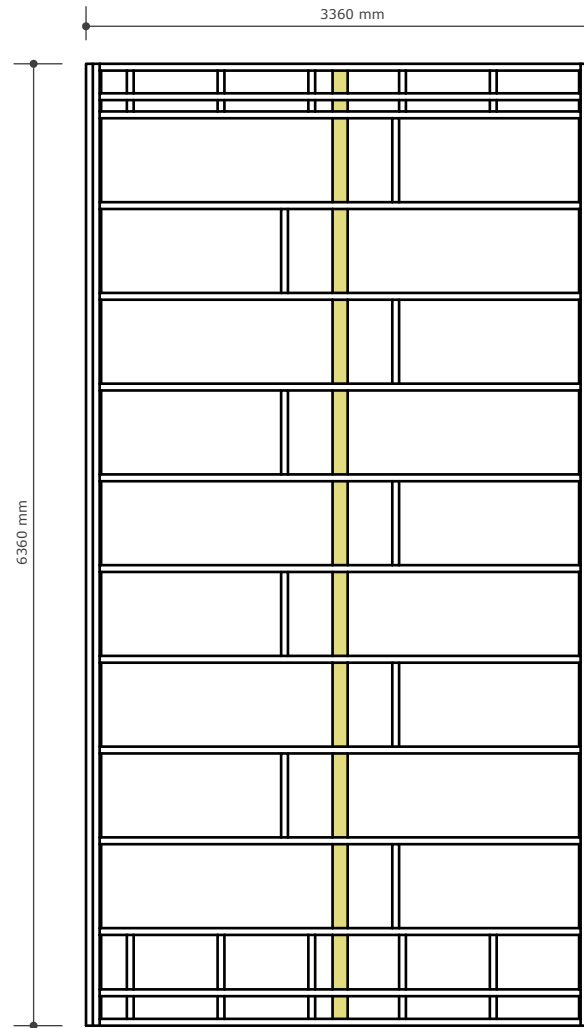
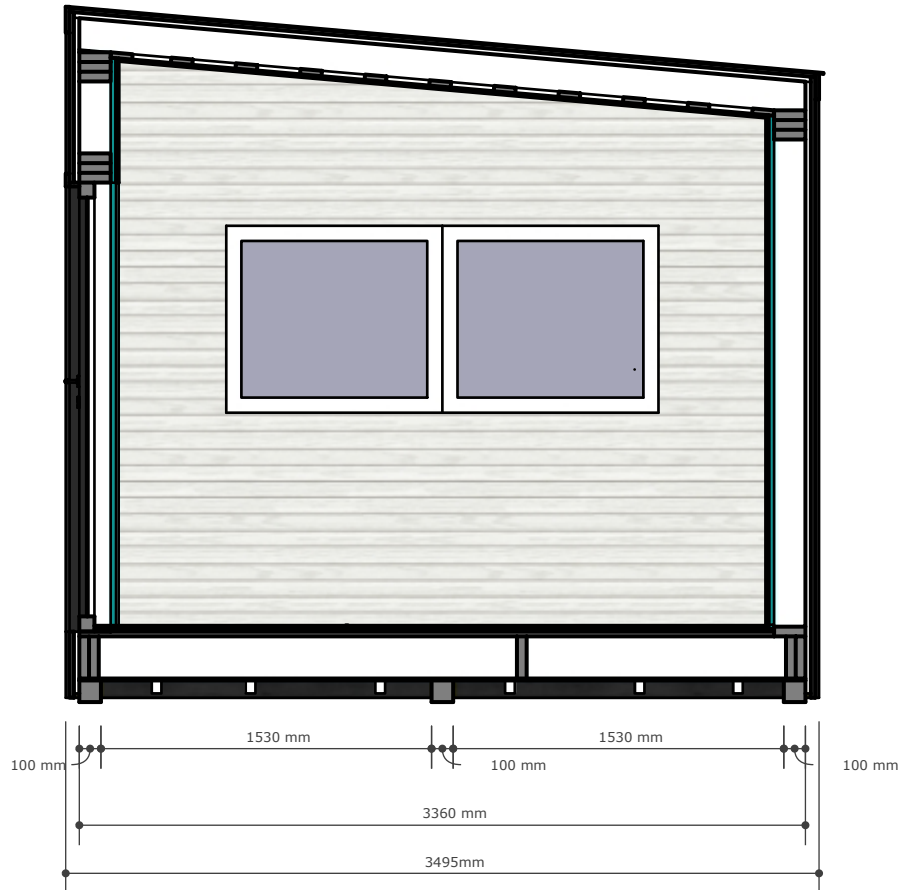



8486 mm



6486 mm

**Pile placement
House 8,5x3,5m**

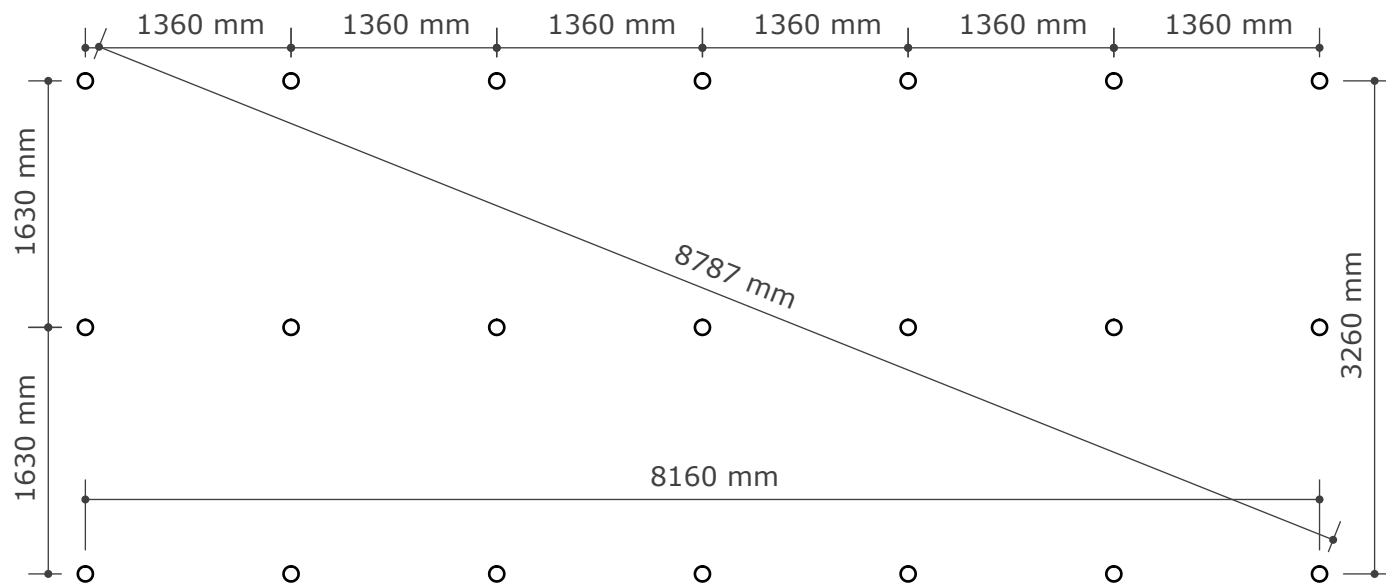

**Pile placement
House 6,5x3,5m**

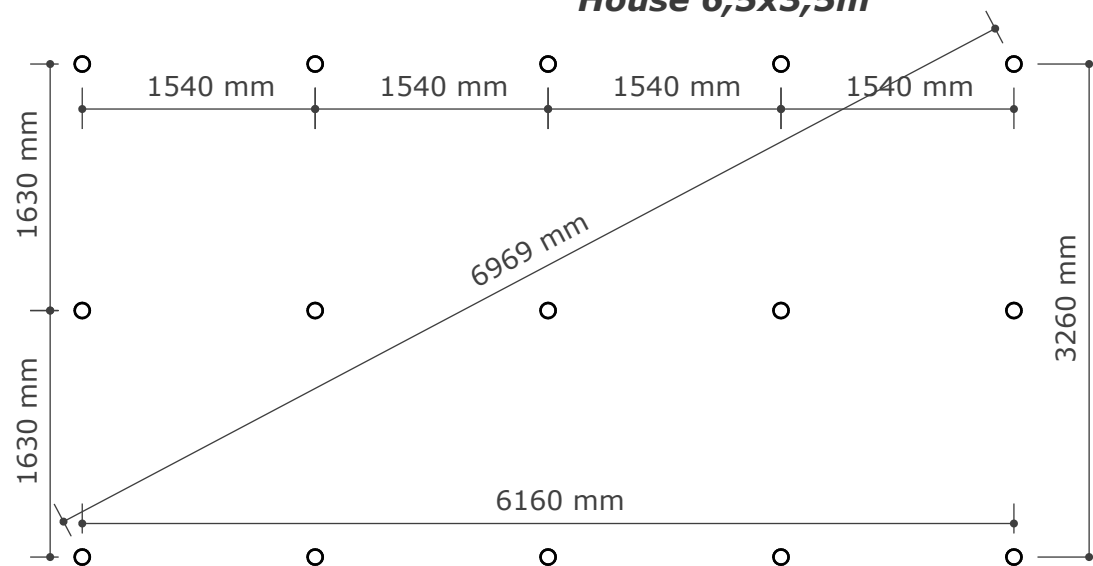

Hidden pipes
House 8,5x3,5m

